

## Multi-Biometric Time Attendance & Access Control System

### eFace-990

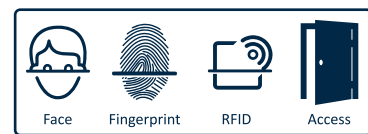

## Specification

### Standard

Fingerprints: 10,000(1:N)  
Faces: 6,000(1:N) 10,000(1:1)  
Cards: 10,000  
Transactions: 1,000,000  
Push Data: Yes

### Optional

Fingerprints: 50,000(1:N)  
Faces: 3,000(1:N) 30,000(1:1)  
Cards: 50,000  
Transactions: 1,000,000

### Hardware

1.2GHz CPU  
Memory 1GB RAM / 1GB Flash  
SilkID Fingerprint Sensor  
4.3 Inches Touch Screen  
Hi-Fi Voice & Indicator  
Tamper Switch Alarm

### Standard Functions

ID Card / Work Code  
DST / SMS / Bell Schedule  
Attendance Status Auto-Switch  
Record Query / Photo ID

### Special Functions

Multiple Biometric Verification Modes  
Alive Finger Detection  
Duplicate Face Detection

### Optional Functions

HID Proxy / Mifare Card Reader  
Wi-Fi / 3G External Printer  
Battery (2,000 mAh)  
POE (Standard IEEE 802.3at)

### Communication

TCP / IP / USB Host / Wiegand Output

### Access Control Interface

Lock Relay Output / Alarm Output /  
Exit Button / Door Sensor / External Bell

### Power

Operating Voltage 12V DC  
Current Draw < 500 mA

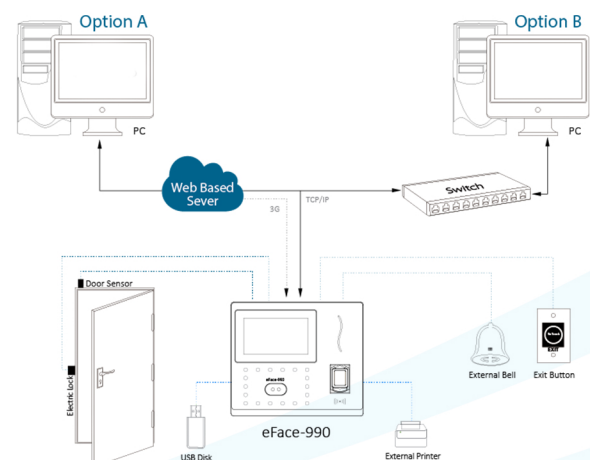

Disclaimer: Brief specifications are mentioned here. Specifications may change without prior notice. Customers are advised to check with us before purchase.

Actual product may differ slightly to that depicted for ongoing product development

[www.esslsecurity.com](http://www.esslsecurity.com)